

INSTALLATION INSTRUCTIONS

ACCESSORIES

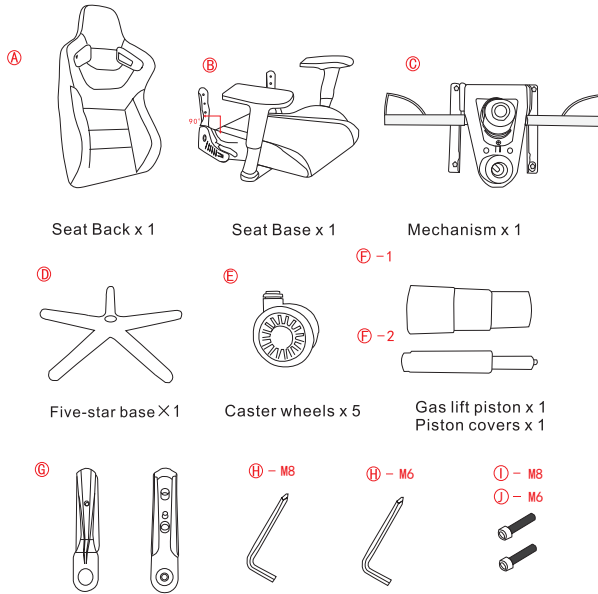

FINISHED PRODUCT

ATTENTION • Please make sure the angle of the adjuster on the seat base is set at 90 degrees (As shown in Figure B)

INSTALLATION INSTRUCTION

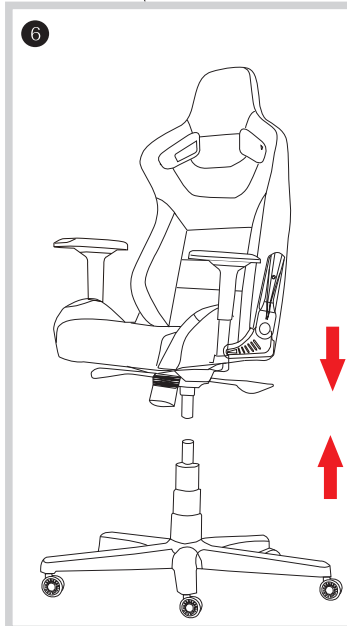
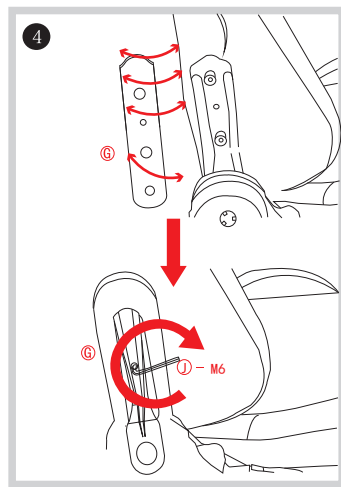
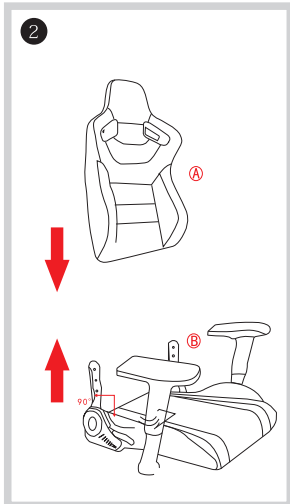
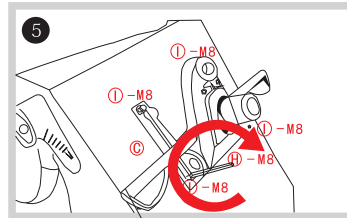
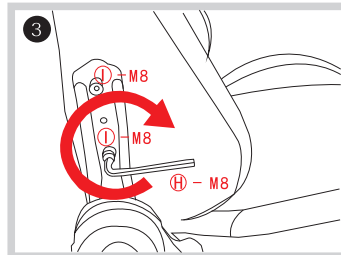
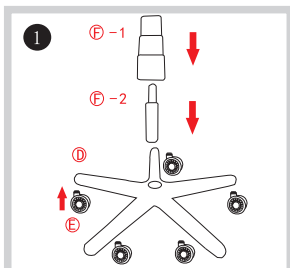

1. Install the casters wheels, gas lift piston and piston covers onto the star base.
2. Put seat back onto the seat base.
3. Take out the m8 screws and use m8 allen key to fix the seat back onto the seat base.
4. Keep the hole sites on the recliner covers aligned with M8 screws, Fix the plastic cover with M6 screws.
5. Mount the mechanism underneath the seat base using 4 x m8 screws. (The screws have been tightened underneath the seat base. please pay attention to the direction of the mechanism and make sure the handle is on the right side.)
6. Insert the gas lift piston onto the notch of the mechanism.

INSTALLATION INSTRUCTIONS

1 SEAT BACKREST ADJUSTMENT

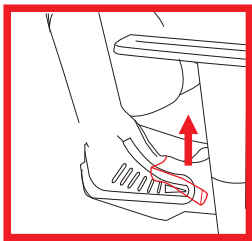
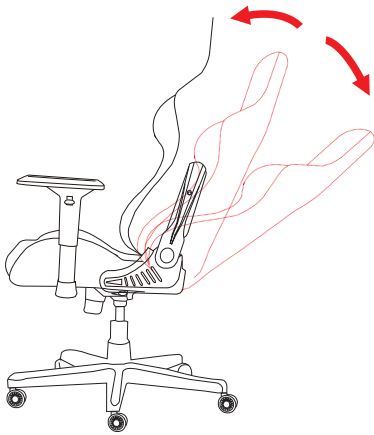

backward of seat backrest: lift up the handle and adjust it to the most comfortable angle.
Retract the backrest: pull the handle upwards, lean against the seat back gently and it automatically goes back.

2 SEAT HEIGHT ADJUSTMENT

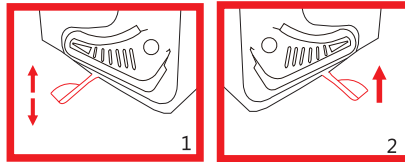
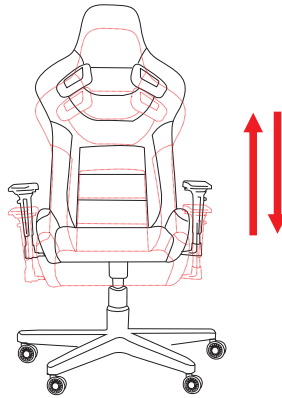

Lower the seat: sit down on the seat and lift up the handle, seat will lower down automatically. (refer to picture 1).
Lift the seat: stand up and pull up the handle, it goes back automatically. (refer to picture 1)
Lock back posture: pull the handle downwards. (refer to picture 2)
Unlock back posture: pull the handle upwards. (refer to picture 2)

3 ADJUSTMENT OF ARMRESTS

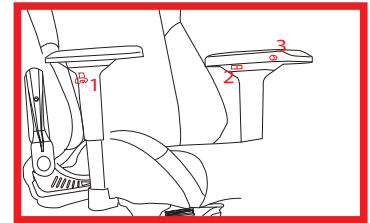
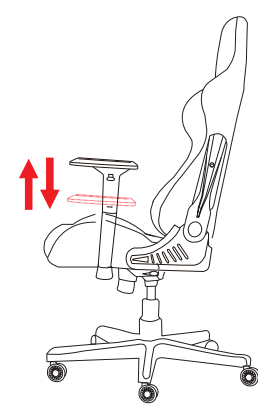

Lift up the armrest: press button (1) under it and then pull up the armrest.
Lower the armrest: press button (1) under it and then lower down the armrest.
press button (2) and pull the armrest leftwards and rightwards.
press button (3) and pull the armrest frontwards and backwards.

Attentions:

1. Please do not use the chair for other purposes.
2. There may be risk of overturn when standing on the chair or use it as a ladder, please be careful.
3. Put a soft cushion under it when installing, in case of any damage to the floor.
4. Please use it on the flat surface in case of turnover .
5. The product is only for a single person use.
6. It might be dangerous to move the chair with goods on it, please be careful.
7. There may be risk of catching fire with inflammables around the chair, please note that.
8. Keep away from direct sunlight.
9. Prohibited use of chair in fire or damp environment .
10. Use a soft dry cloth to clean the chair.
11. If there are stains hard to remove, use a mild detergent, dilute it to 2% degree with hot water, then wipe the seat with a soaked cloth, after that wipe it again with a dry cloth.
12. Prohibited dismantling of gas spring.
13. Other cautions are also described in the instruction, please read it careful.

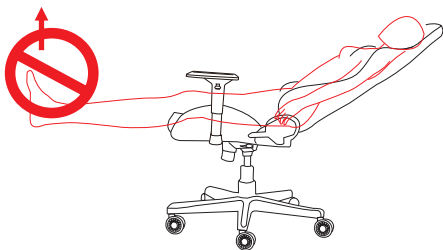

No lifting of feet when lying flat on the chair

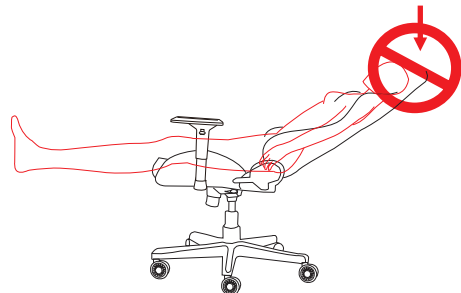

Please don't push the head part when lying flat on the chair